

MIXING CONSOLE OWNER'S MANUAL

MIXING CONSOLE OWNER'S MANUAL

Welcome

ZN24020 EN

Thank you for purchasing the Mixing Console. Please read this manual thoroughly to get the most out of the product and ensure long-term, trouble-free use. After reading this manual, keep it readily available for future reference. For the remainder of this manual the word "mixer" is used instead of "Mixing Console."

Main features

- The built-in 610-670MHz dual-channel microphone Supporting multiple power supply
- Audio interface supports up to 24_bit/192 kHz recording
- Built in six effects DJH.Flexible Routing.,Power from a standard mobile battery
- Bluetooth,MP3,listening function.Reverberation adjustment key mute , key Dodge , Computer insertion

Included Accessories

- 3.5-RCA cable(1.2m),RCA cable(1.2m),6.3-3.5plug
- Power adapter(Another option)
- Owner's Manual(this leaflet)

QUICKSTART GUIDE

STEP1 Connecting speakers, microphones, instruments etc

1. Turn off the power of all speakers, instruments, and other devices to be connected to the mixer
2. Connect speakers, microphones and instruments referring to the connection example below

Connection Example

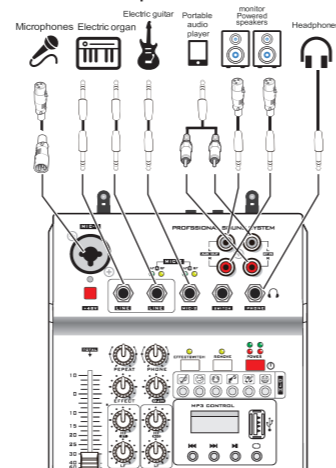

NOTE If you are using condenser microphones, turn on () the +48V phantom power switch

STEP1 Getting sound to the speakers or headphones

- 1 Make sure that all switches including the () (Standby/On) switch are not pressed ().
- 2 When using the [5V DC] terminal on the mixer's rear panel, refer to the notice "Precautions when using the terminals." When connecting a tablet or other device that cannot provide power to the mixer, connect a commercially available USB power adapter or USB mobile battery to the [5VDC] terminal (micro B).

- 3 Turn the [GAIN] knobs, Level knobs, Total volume knob, and Headphones () knob fully to the left (minimum).

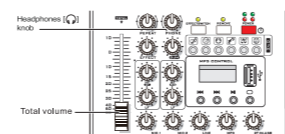

- 4 Make sure that the volume of a powered speaker is set to minimum.
- 5 Turn on the power to connected devices in the following order: Instruments, audio devices → Mixer's () switch → Powered monitor speakers.



- 6 For channels to which a microphone or instrument is connected, set the [GAIN] knob to the 12 o'clock position.

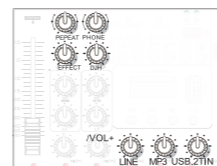

- 7 Speak into your microphone, play your instrument, or play your audio device, and adjust the volume on the powered monitor speakers.
- 8 If no sound is heard, or if you want to adjust the volume, follow the instructions in the boxed section below.

There is no sound, or you need to increase the volume

1. Speak into your microphone or play your instrument, turning the [GAIN] knob to the right so that the corresponding [PEAK] LED flashes briefly.
- NOTE -For optimum volume when using a microphone, place the microphone as close to the sound source as possible.
-If the [PEAK] LED does not light even if the [GAIN] knob has been turned fully to the right, raise the volume of the sound source (instrument, etc.).
- If no sound is heard or the volume does not increase after step 1:
2. If the [GAIN] switch is turned on (), turn the Level knob fully to the left to "0" (minimum), and then turn off () the switches.
 3. Slowly turn the Level knob to the right until the desired volume is reached.

To decrease the volume:

1. Turn the Level knob fully to the left to "0" (minimum), and then turn on () the [GAIN] switch on the channel for which you want to decrease the volume.
2. Slowly turn the Level knob to the right until the desired volume is reached.
3. If the volume does not decrease after the above steps:
Lower the volume of the instrument or audio device.

Mixer Basics: Where Your Sound Goes

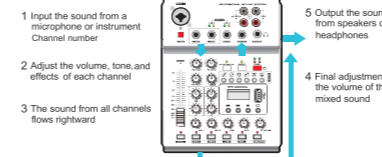

MIXING CONSOLE OWNER'S MANUAL

Controls and functions

3 [MIC/LINE] input jacks

For connecting to a microphone, an instrument, or an audio device. These jacks support both XLR and phone plugs.



4 [LINE] input jacks

For connecting to line-level devices such as an electric organ or an audio device. Channels line support phone plugs. Use the jack on line for instruments, etc. with line output. In this case, the sound input to the jack is output from both the L channel and R channel on the mixer.

5 [+48V] phantom switch / [+48V]

When this switch is turned on (), DC +48 V phantom power is supplied to the XLR plug connected to the MIC/LINE input jack 3 on channel 1. Turn this switch on when using a phantom-powered condenser microphone.

NOTICE

Be sure to leave this switch off () if you do not need phantom power. Follow the important precautions below, in order to prevent noise and possible damage to external devices as well as the mixer if you turn this switch on ().

- Be sure to leave this switch off () when you connect a device that does not support phantom power to channel 1.
- Make sure to turn this switch off () when connecting/disconnecting a cable to/from channel 1.
- Turn the Level knob of the channel 1 to "0" (minimum) before turning this switch on ()/off ().

6 Determines the basic volume for each channel, Phone Listener.

7 Adjust the level of reverberation.

8 Adjust the reverberation time.

9 Determines the basic volume for DJH effects

10 Input music high pitch and bass adjustment

11 Wireless microphone (MIC2) high pitch and bass adjustment

CAUTION

When operating this switch, turn all output controls (such as the Speakers [] knob and Headphones [] knob) fully to minimum. Sudden high level peaks caused by the switching operation can damage external equipment as well as the hearing of those present.

22 [TOTAL] button*

When this switch is turned on (), All voices will be silent.

13 [MIC-1] button*

When this switch is turned on (), MIC-1 voice will be silent.

14 [MIC-2] button*

When this switch is turned on (), MIC-2 voice will be silent.

15 [LINE] button*

When this switch is turned on (), LINE voice will be silent.

16 [MP3] button*

When this switch is turned on (), MP3 voice will be silent.

17 [USB.2TIN] button*

When this switch is turned on (), USB.2TIN voice will be silent.

Level knobs

Set the volume balance between each channel.
MIC1: Adjust the volume of the sound input from the microphone or other source connected to channel 1.
MIC2: Adjust the volume of the sound input from the built-in wireless microphone.
LINE: Adjust the volume of the sound input from the electric keyboard or other source.
2TIN: Adjust the volume of the sound input from the audio device or other source connected to channels 2TIN.

TOTAL: Determines the basic volume for each channel.

18 MP3 control

With bluetooth play With digital display Mp3 (U-DISK Mp3 input) high quality music

1 [OTG/DC-5V] terminal

OTG interface to connect mobile phone or computer to live broadcast drive-free transmission. A USB power adapter or USB mobile battery is not included with the mixer

2 [3.5mm] terminal

IN: Mobile Phone Recording Connect to In Interface
OUT: Audio output connected to out interface

NOTICE

- Please read the safety precautions for the USB power adapter or USB mobile battery you are using.
- Use a USB power adapter or USB mobile battery that can supply power via a USB micro B plug based on the following USB standards:
Output voltage: 4.8V to 5.2V
Output current: 0.5A or greater

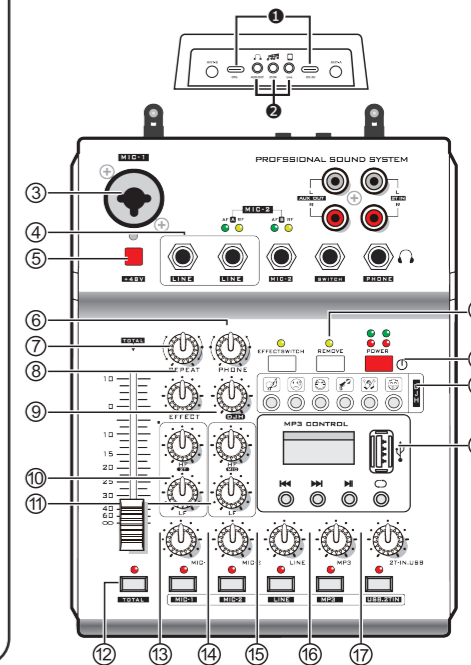

Recording function:

1. Insert USB drive first
2. Press D button to set in. AB key to choose, select LINEN, press C key to confirm. Then press the D key to enter the recording selection, press the A key or the B key to confirm the instant recording ("REC" characters flashing, that is, recording, recording files stored in memory disk)

19 6 kinds of atmospheresound effect

The tone of the atmosphere is: scorn, shame, laughter, gunshot, laughter

20 [Standby/On] switch

For turning the power of the unit to standby () and on ().

NOTICE
Rapidly switching the () switch between on and standby in succession can cause the mixer to malfunction. After switching the () switch to standby, wait for at least six seconds before turning it on again.

21 When this switch is turned on (), When the microphone speaks, the volume of music automatically decreases.

ID-to-frequency

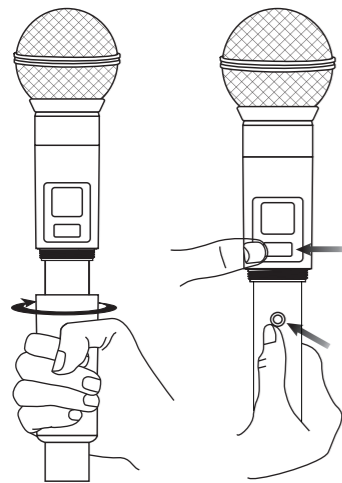

- ① Power off the handheld and the mixer.
- ② Press handheld power key and FM key at the same time until the handheld display flashes
- ③ Power off the mixer, turn off the handheld power back on, Mic2 light, that is, complete the operation

Frequency adjustment

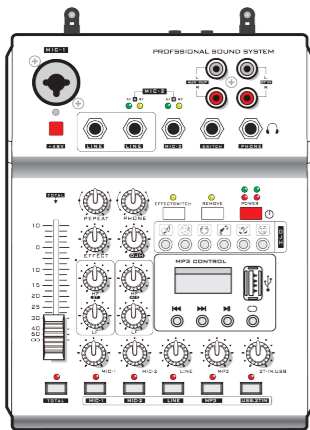

When the mixer and hand-held ID to good, press the handheld frequency key, the handheld frequency changes, the mixer frequency changes

Connect the rear level amplifier

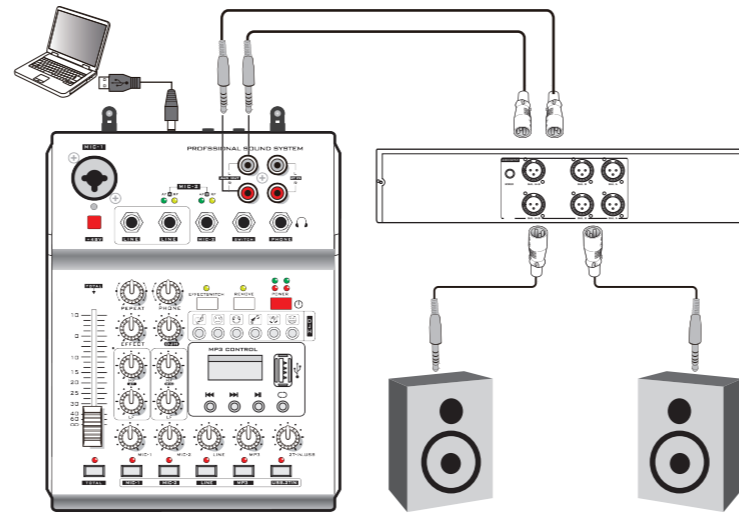

Connecting an active speaker

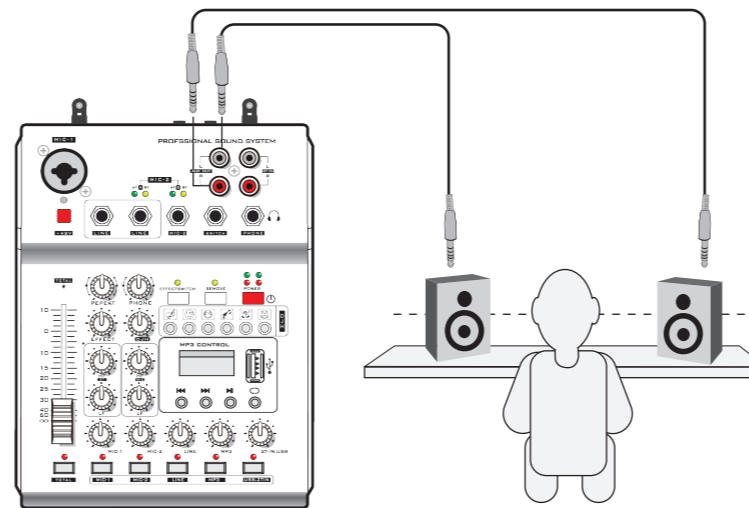

General Specifications

Input Channel 1: Mono(MIC/LINE) 2: OTG 3: AUX IN	
3 signals / microphone mono input. Built in two wireless microphone	
LCD digital display, digital effects.	
built-in 48V phantom power for condenser microphone for professional recording.	
Built-in six effects sound	
two-way (L / R) recording output.	
all the way to send the output, all the way to return to the input, an auxiliary input.	
a group STEREO stereo mix output.	
each of the road to features listen to switch.	
all the way to high-fidelity high-power headphone outputs (1W).	
the headphones listen function.	
Input Sensitivity	MIC-60dB
	LINE-20dB
	Eff Ret-20dB
	Tape In-20dB
DSP effects	24 Bit/48K Sample
the signal-to-noise ratio	> 105dB
distortion degree (THD)	0.01% (1KHz Full Power)
frequency response	18Hz- 18KHz±3dB
power supply	AC220V/50HZ output voltage: 4V Max
Power Consumption	30 -400W

For their pecifications,see the included“Technical Specifications”

The contents of this manual apply to the latest specifications as of the printing date. Since our company makes continuous improvements to the product, this manual may not apply to the specifications of your particular product. Since specifications, equipment or separately sold accessories may not be the same in every locale, please check with your dealer.